

GO.VIDEO® DV2150

Read Me First

Unpacking & Basic Connections [for Cable Box and other advanced connections please refer to the User's Guide

1

UNPACK YOUR DVD+VCR

- DV2150 DVD+VCR (1)
- Remote control (1)
- 1.5V AAA alkaline batteries (2)
- RF (Antenna) cable (1)
- Audio/video cable (1)
- User's guide (1)
- Quick reference guide (1)
- Product registration card (1)

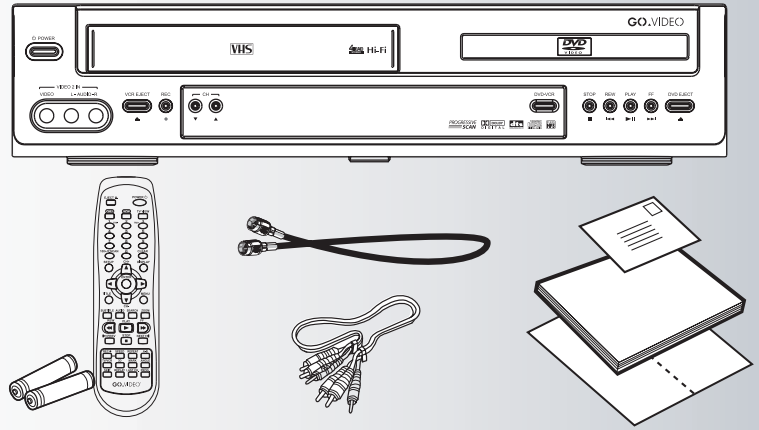

2

INSERT REMOTE CONTROL BATTERIES

- 1 Remove battery cover on back of remote control.
- 2 Insert two 1.5V AAA batteries, paying attention to the correct polarities (+/-).
- 3 Replace cover.

3

BASIC CONNECTIONS

- 1 Connect your antenna or cable TV wall outlet to the IN (FROM ANT.) jack on the DVD+VCR rear panel.
- 2 Connect the OUT (TO TV) jack on the DVD+VCR rear panel to your TV's Antenna Input using the supplied RF antenna cable.

OR

For improved picture quality, connect the VIDEO OUT jacks on the back panel of the DVD+VCR to your TV's Line In jacks using the supplied audio/video cable.

- 3 Plug in the DVD+VCR.
- 4 Press the POWER button on the remote control or front panel of the unit.
- 5 Press the POWER button on your TV.
- 6 Set your TV to Channel 3. If you used the Video Out connections, set your TV to its line or video input.
 - You *must* use either the Antenna or Line connection between your TV and DVD+VCR, even if you plan to use the S-Video or Component Video Output for improved DVD picture quality. The S-Video and Component Video Outputs are for DVD playback only!

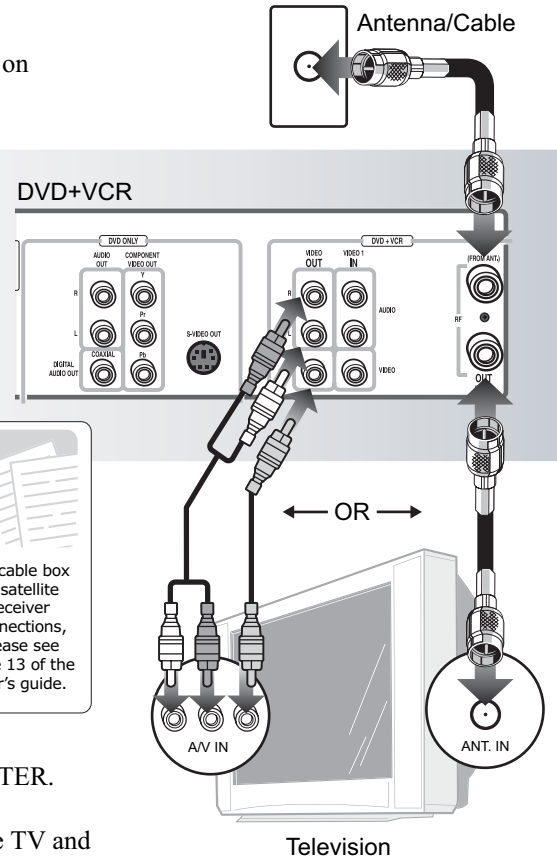

4

AUTO SEARCH FOR CHANNELS

- 1 Press SETUP to display the SETUP menu.
- 2 Use the ▲/▼ buttons to select CHANNEL SET and press ENTER.
- 3 Use the ▲/▼ buttons to select AUTO CHANNEL SEARCH and press ENTER.
- 4 Use the ▲/▼ buttons to select "Detect Automatically" and press ENTER.
 - Auto Channel Search detects whether you are using an Antenna or Cable TV and memorizes all available channels automatically. This may take several minutes.
 - When Auto Channel Search is complete, the DVD+VCR will display the lowest channel found.
- 5 To browse memorized channels, press the CH+/- buttons.

1

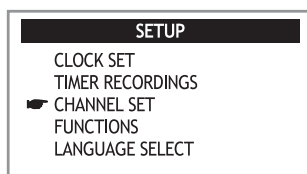

2

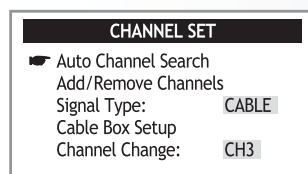

3

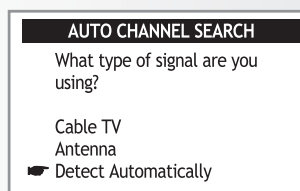

4

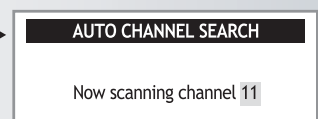

Basic Operations

5 BASIC CONTROLS

Two Decks, One Set of Controls!

VCR Button

- Press to control the VCR deck. All deck control keys will operate the VCR.

DVD Button

- Press to control the DVD deck. All deck control keys will operate the DVD player.

TV VIEW Button

- Press to change the on-screen view to AV1 (external device connected to the rear AV inputs), AV2 (external device connected to the front AV inputs), VCR, and DVD.

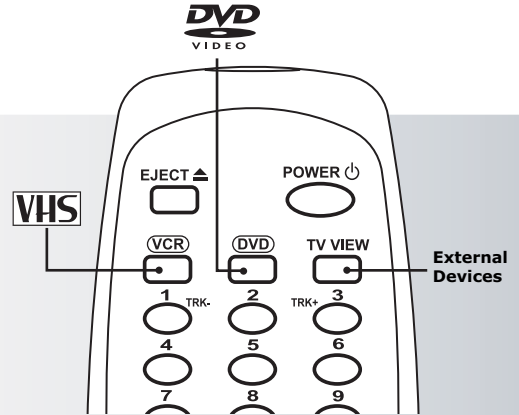

6 BASIC DISC PLAYBACK

To Play a DVD or CD

- 1 Press EJECT ▲ on the remote control or front panel to open the disc drawer.
- 2 Place the disc in the drawer with the label side facing up. If the disc has two sides, place the disc with the desired side facing up.
- 3 Press EJECT ▲ again to close the disc drawer.
- 4 Press PLAY ►" to begin playback.
 - If the DVD has a disc menu, or more than one title, the disc menu may appear. If so, use the arrow keys to highlight menu items, then press ENTER to make selections.

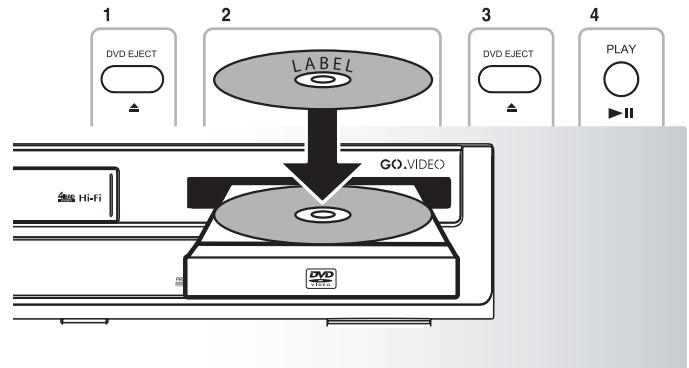

7 BASIC VCR PLAYBACK

To Play a VHS Tape

- 1 Insert a VHS tape into the VCR deck. The DVD+VCR will power on automatically when you insert the tape.
- 2 Press PLAY ►" to begin playback.
 - If the tape is missing the record safety tab and Auto Play is turned on, the tape will begin playing automatically.

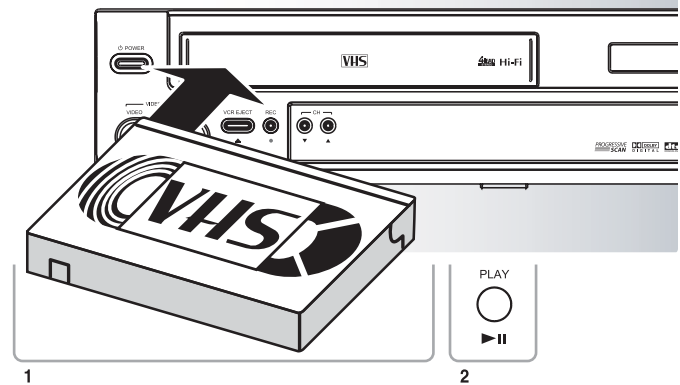

Questions?



DO NOT RETURN THIS PRODUCT TO THE STORE!

Our Award-Winning Customer Service Professionals are Ready to Help!

- 1 Call Us! **1-800-736-7679**
- 2 E-Mail Us! **customerservice@govideo.com**
- 3 Visit Our Web Site! **www.govideo.com**

For detailed instructions and descriptions of features, please consult the User's Guide